

## Suppository Moulds 150 × 2g

Order code: 7001.21502

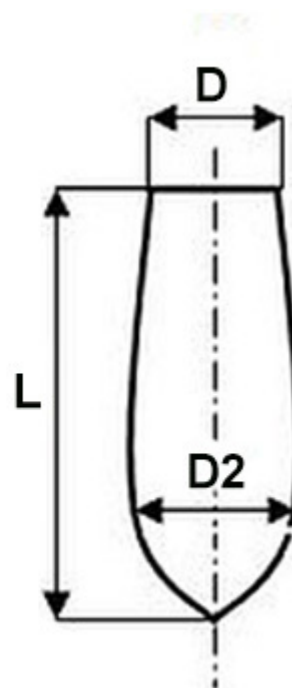

Cena bez DPH 1.344,00 Eur  
 Price with VAT 1.626,24 Eur

### Parameters

Suppository moulds - shape	Torpedo
Number of	150 × 2 g
Length [mm]	30
Diameter [mm]	8,6
Diameter D2 [mm]	10,6
Quantitative unit	ks

These are basic types of moulds for rectal suppositories and vaginal globules. Their design respects the experience and requirements of pharmaceutical and medical practice. The moulds are made of duralumin. Their inner surface is coated with silicon resin which prevents the contact of the moulded material with the metal of the mould, and guarantees maximum inertness of the mould.

The moulds have been certified by the State Institute for Drug Control in Prague and have been recommended for use in pharmaceutical and medical practice. The construction of the moulds guarantees long-lasting functional properties and quality.

Torpedo shape [g, ml]	Length [mm]	Maximum Diameter [mm]	Peak Diameter [mm]
1	23	8,6	7,4
2	30	10,6	8,6
4	36,5	13,2	11